

RESIDENTIAL LAND PROPOSAL

FP : 805
Village : Bhangadh
Zone : Residential
TP : 4B2
Survey no. : 53
Road : 48 MT Road
Area : 19136 sq yard

DHOLERA SIR FINAL PROPOSED LAND USE PLAN

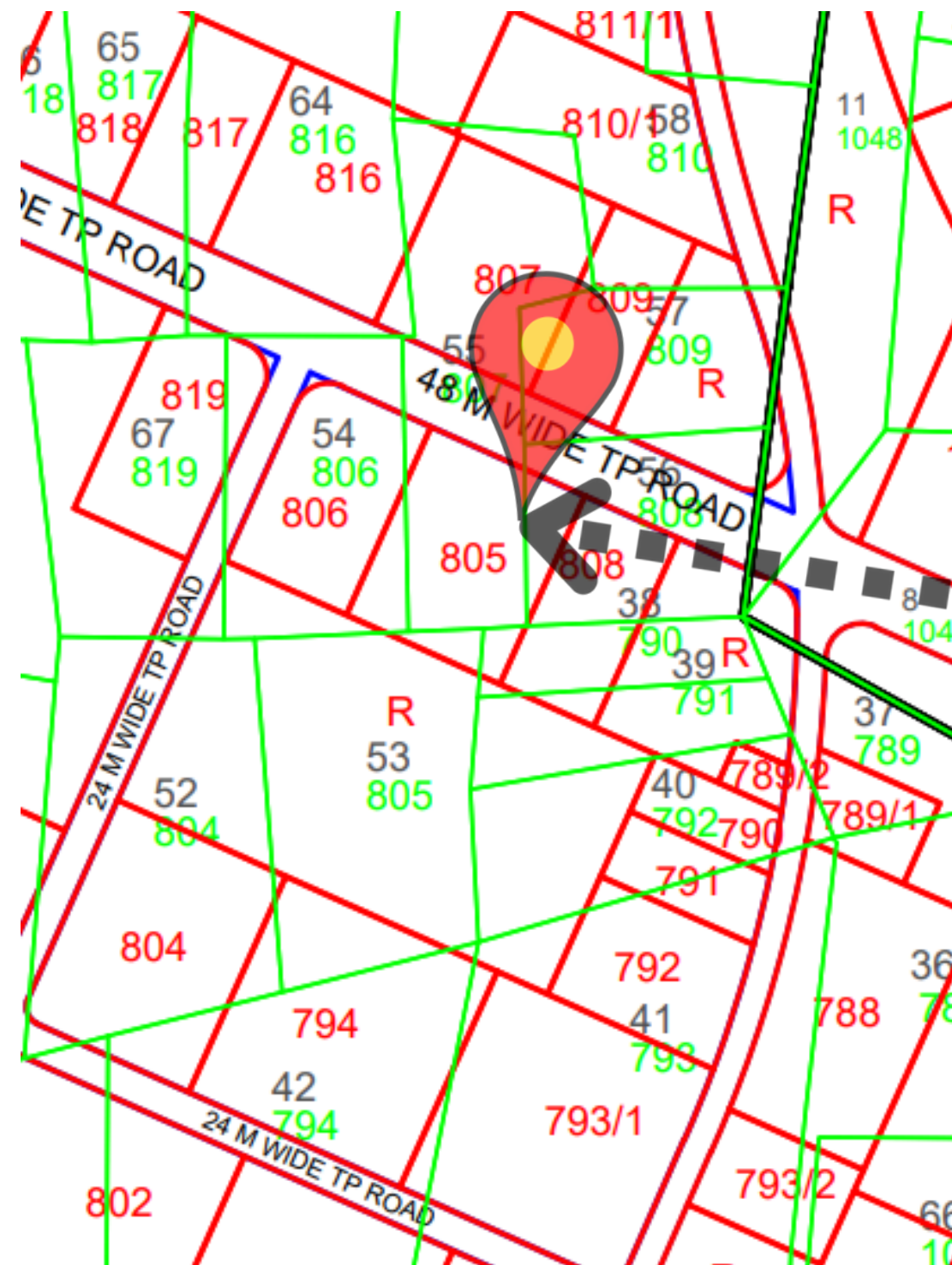

48 MTR Road

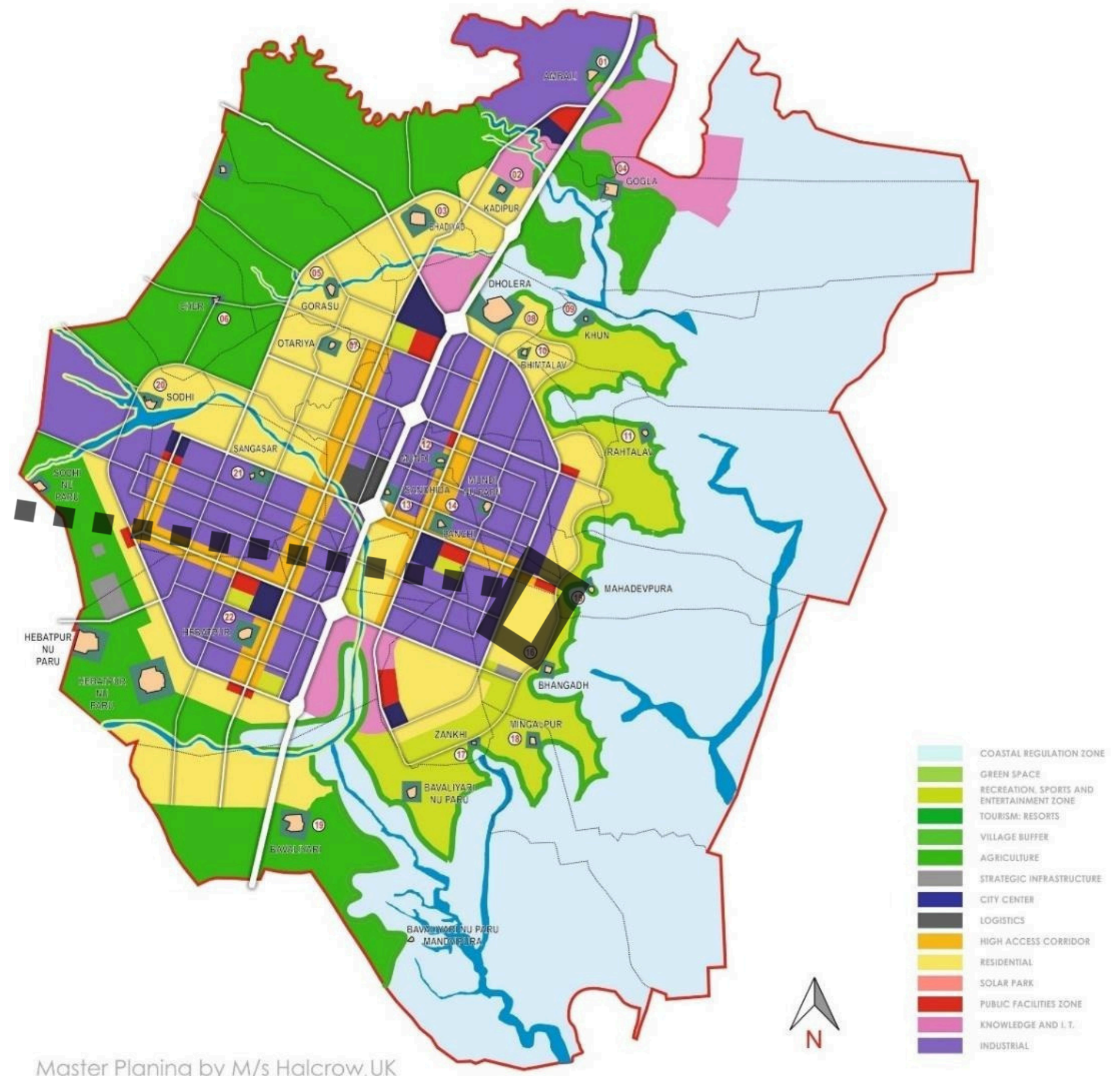

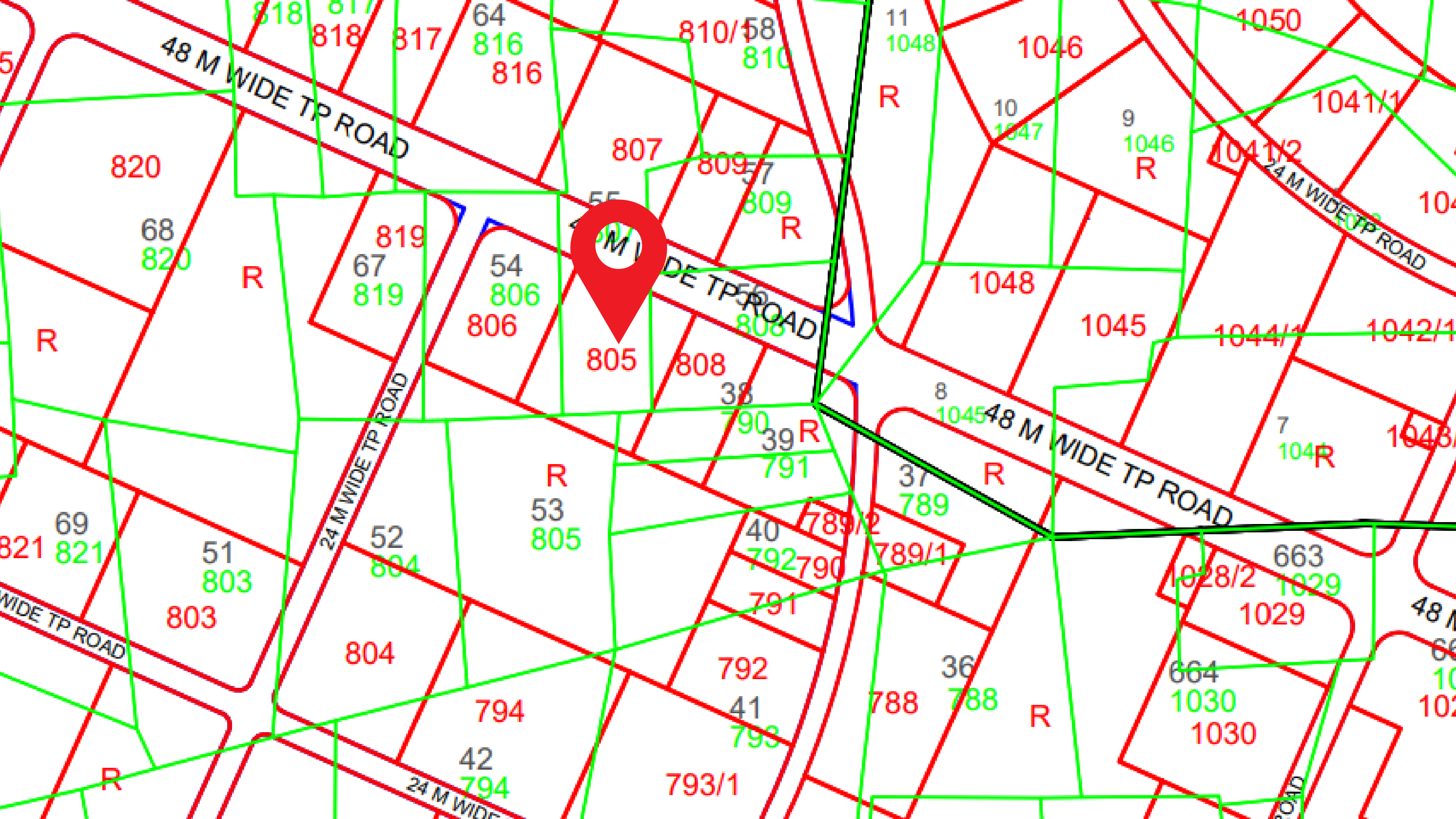

DISTANCE

dholera
— A NEW ERA —



**Dholera
International
Airport**

**APPROX.
10 KMS**

**Metro Route
Orange line**

**APPROX.
5 KMS**

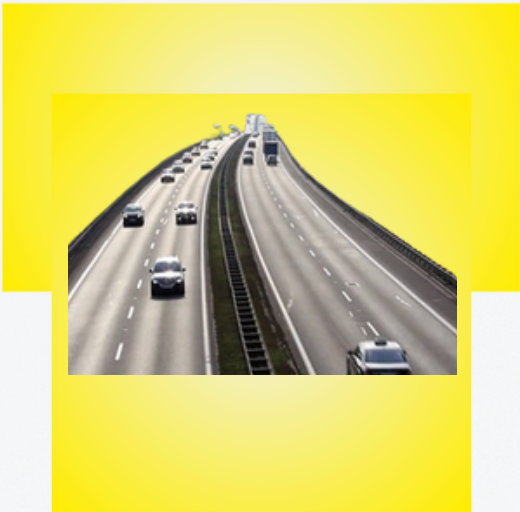

**250 Meter
Expressway**

**APPROX.
5 KMS**

**Residential
Zone**

**APPROX.
0 KMS**



**CITY CENTER
Zone**

**APPROX.
1 KMS**

Permission In Residential



SR NO	MINIMUM ROAD ROW (METRES)	MAXIMUM FAR	MAXIMUM GROUND COVERAGE AS PERCENT OF PLOT AREA	MAXIMUM BUILDING HEIGHT	MINIMUM SETBACKS (FRONT- REAR- BOTH SIDES)	PERMITTED USE PREMISES	CONDITIONAL USE SUBJECT TO SPECIAL PERMIT FROM DSIRDA
RESIDENTIAL ZONE							
1	55 and above	2	60%	G+5 or 18m whichever is less	5m – 6m – 6m – 6m	Cinema Hall, Retail Mall, Petrol/CNG/LPG Pump, Bank, Hospital A and B and all uses given in (2) and (3) below	The following uses may be permitted subject to approval of a special permit on a case-by-case basis: • Cemeteries/ Burial Ground • Broadcasting towers and line-of-site relay devices
2	25 to Below 55	1.5	60%	G+3 or 15m whichever is less	5m – 5m – 5m – 5m	(2) Neighbourhood Retail/Service Shop, Restaurant/Café, Hawker Zone, Designated Vegetable Market/bazaar, Commercial Centre, Primary and Secondary School; Multi-purpose ground larger than 5 ha; Place of Worship on Plot larger than 1000 sq m; Service/Repair Shop; Veterinary Hospital; Public Facility/Infrastructure/Utility Buildings; and all uses given in (3) below	for telephonic, radio or television communications The following uses and structures shall be permitted as ancillary uses to the main use of the building provided their name, location and size (if applicable) is indicated in the site plan submitted for approval. 1. Part of a residence may be permitted for use as professional office for advocates, chartered accountants, architects, doctors, engineers or the like, or as a small scale home based workshop subject to the following conditions:
3	Below 25	1	50%	G+2 or 10m whichever is less	3m - 3m - 3m – 3m	(3) Multi-storey apartment and clusters thereof; Row-house, Villa/Bungalow; Multi-purpose ground smaller than 5 ha; Terraced/Row House; Villa/Bungalow; Housing for EWS; Night Shelter; Old-Age Home; Maternity Home, Nursing Home, Kindergarten, Day-care, Dispensary, Veterinary Clinic, Health-club, Place of Worship on plot smaller than 1000sqm, Community Hall, Health-Club, Swimming Pool	<ul style="list-style-type: none"> • it is not located in a multi-storey apartment; • the number of employees do not exceed 10; • it does not involve installation and use of heavy machinery, and does not create noise, vibration, fume or dust; • separate means of access and a designated parking area for staff and visitors is provided and marked on the site plan submitted for approval. 2. Devices for generation of non-conventional energy, such as solar panels, wind power 3. Servant quarters or lodging facilities for

Dholera Investment Guide

OUR SERVICE

- Residential plots
- Commercial land
- Industrial land
- Resale properties



help@we9properties.com



www.we9properties.com



Vishal Prajapati



www.we9properties.com



help@we9properties.com